

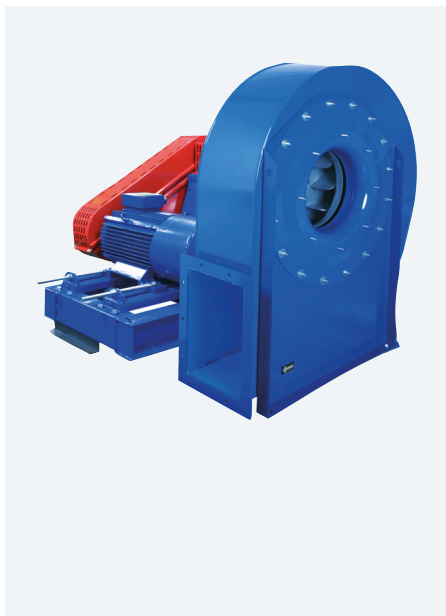

MTGR

Different configurations of free shaft without motor or belt driven motor

Eje libre sin motor o motor a transmisión en diferentes configuraciones



MANUFACTURING FEATURES

- Rolling steel sheet housing, fully welded and protected against corrosion with polyester powder finishing coat.
- Forward models (MTCA) with galvanized sheet impeller, and backward models (rest of series) with sheet steel impeller protected against corrosion by polyester resin coating.
- The fan is supplied with free axle (sist.1), that is: without motor, pulleys or belts or with motor and transmission set (syst.9 and 12).
- For models with motor: standard squirrel cage asynchronous motor with IP-55 protection and class F insulation. Standard voltages 230/400V 50Hz for three-phase motors up to 4kW and 400/690V 50Hz for higher powers.
- Optional front support up to size 500, size 560 and upper front support is included.

APPLICATIONS

Designed for inline installation, they are suitable for:

- Industrial applications, air extraction or injection.
- Cooling of machines and parts.
- Clean air and pneumatic transport.
- Clean air or slightly dusty air transport (MTCA and MTRL).
- Transport of dusty air or with low load of granulated materials (MTRM y MTRU).
- Solid material transport and textile fibers (MTGR and MTZM P/R).

UNDER REQUEST

- Fans for special voltages.
- 2 speed motor.
- C4 or C5 coating painting.
- Hot dip galvanized.
- Special steel (Cor-Ten A, Hardox...).
- Inox 304 (normal or electropolished finish).
- Inox 316 (normal or electropolished finish).
- Cooling wheel.
- Anticorrosive paint.
- Reinforced housing.
- Fully welded housing (waterproof).
- Welded impeller.
- Insulated housing.
- Split casing (for big sizes).
- Inspection door to facilitate maintenance and cleaning.
- Drain plug.
- Airtight shaft.
- Frontal foot.
- Double suction flange.
- Available in non-sparking air passage and standard motor.
- Other brands of motors.
- Orientation: RD0, RD45, RD90, RD135, RD180, RD225, RD270, RD315, LG0, LG45, LG90, LG135, LG180, LG225, LG315

This is a belt driven range, each model can be manufactured at different rpm, in case of order should be indicated the desired rpm for the correct operation of the unit and according to the needs.

CARACTERÍSTICAS CONSTRUCTIVAS

- Carcasa fabricada en chapa de acero laminado totalmente soldada y protegida contra la corrosión mediante recubrimiento en polvo de resina de poliéster.
- Turbina de chapa galvanizada para modelos a acción (MTCA) o de chapa de acero para los de reacción (resto de series) protegida contra la corrosión mediante recubrimiento de resina de poliéster.
- El ventilador se suministra a eje libre (sist.1), es decir: sin motor, poleas ni correas o con motor y conjunto de transmisión (sist.9 y 12).
- Para modelos con motor: motor asíncrono normalizado de jaula de ardilla con protección IP-55 y aislamiento clase F. Voltajes estándar 230/400V 50Hz para motores trifásicos hasta 4kW y 400/690V 50Hz para potencias superiores.
- Pie delantero opcional hasta tamaño 500, tamaño 560 y superiores pie delantero incluido.

APLICACIONES

Diseñados para instalación en conducto, son indicados para:

- Procesos industriales, extracción o inyección localizada.
- Refrigeración de máquinas, enfriamiento de piezas.
- Aire limpio y transporte neumático.
- Transporte de aire limpio o ligeramente polvoriento (MTCA y MTRL).
- Transporte de aire polvoriento o con ligera carga de materiales granulados (MTRM y MTRU).
- Transporte de materia sólida y fibra textil (MTGR y MTZM P/R).

BAJO DEMANDA

- Ventiladores para voltajes especiales.
- Motor 2 velocidades.
- Acabado pintura C4-C5.
- Galvanizado en caliente.
- Aceros especiales (Corten, Hardox...).
- Inox 304 (acabado normal o electropulido).
- Inox 316 (acabado normal o electropulido).
- Rodete de refrigeración.
- Pintura anticorrosiva.
- Carcasa reforzada.
- Carcasa totalmente soldada (estanca).
- Turbina con palas soldadas.
- Carcasa aislada.
- Carcasa partida (para tamaños grandes).
- Puerta inspección para facilitar el mantenimiento y la limpieza.
- Drenaje.
- Eje estanco.
- Pie frontal.
- Doble anillo aspiración.
- Disponibles con paso de aire antichispas y motor estándar.
- Otras marcas de motores.
- Orientación: RD0, RD45, RD90, RD135, RD180, RD225, RD270, RD315, LG0, LG45, LG90, LG135, LG180, LG225, LG315.

Esta gama es a transmisión, cada modelo se puede fabricar a distintas rpm, en caso de pedido se debe indicar las rpm a las que desea el equipo para que el modelo quede correctamente definido y sea adecuado a sus necesidades.

ACCESSORIES / accesorios



INT
Interruptor de corte
Safety switch



BAD
Brida de acoplamiento circular-circular.
Circular-Circular coupling flange.



FS
Pie soporte delantero para ventiladores de media y alta presión
Front support for medium and high pressure fans



RA
Rejilla aspiración
Inlet protection guard



SFC
Variador de velocidad frecuencial
Frequency speed controller



SIL-C
Silenciador circular aspiración/impulsión
inlet-outlet circular silencer



BA-400
Brida antivibratoria 400°/2h.
Anti-vibrating flange 400°/2h.



RI
Reja impulsión
Outlet guard



AVR
Amortiguador antivibrátil de caucho
Anti-vibration rubber block



EI
Embocadura impulsión
Outlet flange



AC
Brida conexión
Connection flange



AVS
Amortiguador de muelles
Spring anti-vibration block



JE 45
Junta elástica
Flexible joint



AB
Cabinas acústicas para ventiladores centrífugos Casals
Acoustic cabins for Casals centrifugal fans

BELT DRIVEN / transmisión

Code	Model	R.P.M. min	R.P.M. max	Rated Power kW	Air flow m³/h	Sound dB (A)	Weight Kg	Connection diagram
5047040_R	MTGR 400	2.550	3.500	9	4.690	64	(s.1) 80	1
5047045_R	MTGR 450	2.250	3.500	11	6.220	71	(s.1) 95	1
5047050_R	MTGR 500	2.000	3.500	15	9.320	74	(s.1) 135	1
5047056_R	MTGR 560	1.800	3.500	22	13.260	78	(s.1) 187	1
5047063_R	MTGR 630	1.600	3.500	37	18.640	80	(s.1) 218	1
5047071_R	MTGR 710	1.450	3.200	55	24.890	84	(s.1) 336	1
5047080_R	MTGR 800	1.250	2.900	75	32.950	85	(s.1) 400	1
5047090_R	MTGR 900	1.150	2.400	75	38.360	87	(s.1) 489	1
5047100_R	MTGR 1000	1.000	2.200	90	46.480	86	(s.1) 694	1
5047112_R	MTGR 1120	900	1.900	90	53.650	86	(s.1) 945	1
5047125_R	MTGR 1250	800	1.800	160	76.780	89	(s.1) 1.147	1
5047140_R	MTGR 1400	750	1.600	200	95.190	91	(s.1) 1.628	1
5047160_R	MTGR 1600	650	1.400	200	111.860	91	(s.1) 1.888	1
5047180_R	MTGR 1800	600	1.250	315	150.670	91	(s.1) 2.670	1
5047200_R	MTGR 2000	500	1.100	315	179.650	100	(s.1) 3.600	1

DIMENSIONS / dimensiones

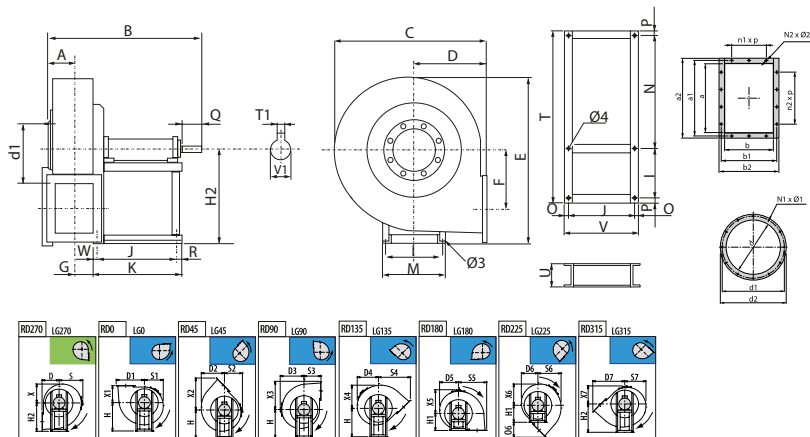

MODEL	Ø 3	Ø 4	A	B	C	D	D1	D2	D3	D4	D5	D6	D7	E	F	G	H	H1
MTGR 400	14	15	105	776	685	285	483	387	400	353	315	306	543	815	319	97	500	285
MTGR 450	14	15	115	795	765	320	541	435	445	398	354	342	609	914	357	107	560	320
MTGR 500	17	18	131	956	862	360	597	490	502	450	400	380	676	1000	396	119	600	360

MODEL	H2	I	J	K	M	N1xØ1	N2xØ2	O	O6	P	Q	R	S	S1	S2	S3	S4	S5
MTGR 400	500	355	407	485	400	8x10	10x12	28	258	23	80	28	400	315	306	285	543	483
MTGR 450	560	355	407	485	400	8x12	10x12	28	289	23	80	28	445	354	342	320	609	541
MTGR 500	600	364	477	560	418	8x12	10x12	33	316	27	110	33	502	400	380	360	676	597



MODEL	S6	S7	T	T1	U	V	V1	W	X	X1	X2	X3	X4	X5	X6
MTGR 400	387	353	10	10	120	38	38	50	315	285	543	483	387	400	353
MTGR 450	435	398	10	10	120	38	38	50	354	320	609	541	435	445	398
MTGR 500	490	450	12	12	140	42	42	50	400	360	676	597	490	502	450

MODEL	X7	a	a1	a2	b	b1	b2	d	d1	d2	n1xp	n2xp
MTGR 400	306	258	292	328	185	219	255	255	292	325	1x112	2x112
MTGR 450	342	288	332	368	205	249	285	285	332	365	1x125	2x125
MTGR 500	380	322	366	402	229	273	309	320	366	400	1x125	2x125

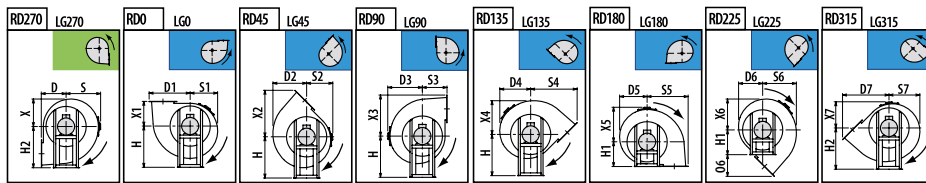
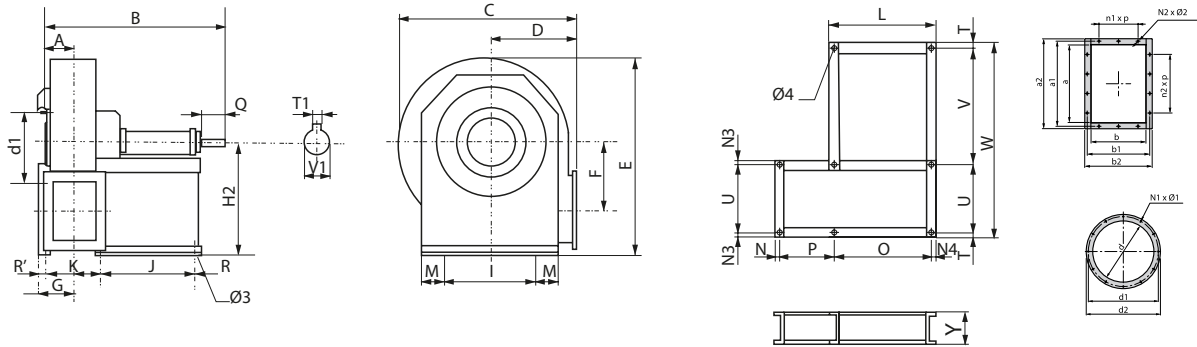

MODEL	Ø3	Ø4	A	B	C	D	D1	D2	D3	D4	D5	D6	D7	E	F	G	H	H1
MTGR 560	17	18	142	1031	970	400	657	555	570	542	485	425	747	1155	436	181	670	400
MTGR 630	17	18	158	1069	1080	450	732	619	630	603	540	476	836	1290	490	197	750	450

MODEL	H2	I	J	K	L	M	N1	N1xØ1	N2xØ2	N3	N4	O	O6	P	Q	R	S	S1
MTGR 560	670	632	477	341	543	30	33	8x12	10x12	30	33	477	347	341	110	33	570	485
MTGR 630	750	702	477	372	543	30	33	12x12	14x12	30	33	477	386	372	110	33	630	540

MODEL	S2	S3	S4	S5	S6	S7	T	T1	U	V	V1	W	X	X1	X2	X3	X4	X5
MTGR 560	425	400	747	657	555	542	30	14	632	678	48	1370	485	400	747	657	555	570
MTGR 630	476	450	836	732	619	603	30	14	702	708	48	1470	540	450	836	732	619	630

MODEL	X6	X7	Y	a	a1	a2	b	b1	b2	d	d1	d2	n1xp	n2xp
MTGR 560	542	425	160	361	405	441	256	300	336	360	405	440	1x125	2x125
MTGR 630	603	476	160	404	448	484	288	332	368	405	448	485	2x125	3x125

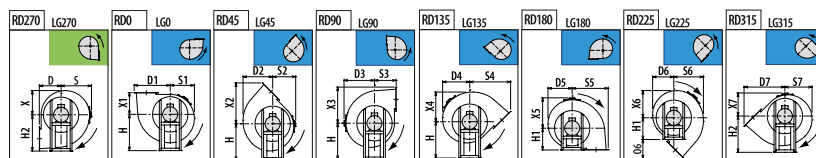
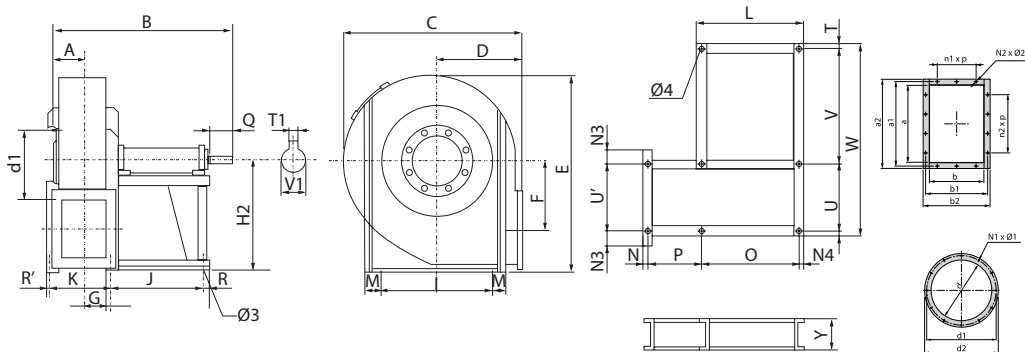

CENTRIFUGAL MEDIUM PRESSURE FANS / BELT DRIVEN

Ventiladores centrífugos de media presión / a transmisión



MODEL	Ø 3	Ø 4	A	B	C	D	D1	D2	D3	D4	D5	D6	D7	E	F	G	H	H1
MTGR 710	19	20	185	1158	1190	500	825	719	690	662	596	497	937	1446	558	221	670	500
MTGR 800	19	20	199	1214	1342	560	919	811	782	749	672	562	1045	1622	625	260	755	560
MTGR 900	19	20	221	1257	1500	630	1038	905	870	835	721	633	1179	1781	703	282	850	630
MTGR 1000	19	20	246	1449	1686	710	1160	1015	976	936	813	718	1322	1993	791	326	950	710
MTGR 1120	24	25	277	1649	1884	800	1300	1123	1084	1037	932	793	1487	2252	891	353	1060	800
MTGR 1250	24	25	310	1710	2114	900	1464	1270	1214	1163	1048	898	1671	2548	1003	384	1190	900
MTGR 1400	24	25	344	1887	2325	1000	1625	1395	1325	1272	1145	990	1856	2845	1116	449	1320	1000
MTGR 1600	28	30	387	2175	2620	1120	1814	1572	1500	1434	1277	1085	2075	3177	1250	488	1500	1120
MTGR 1800	28	30	431	2270	2760	1250	2030	1790	1710	1610	1470	1300	2322	3590	1395	531	1650	1250
MTGR 2000	28	30	600	2395	3300	1400	2267	1970	1900	1811	1634	1455	2595	3994	1563	599	1850	1400

MODEL	H2	I	J	K	L	M	N	N1	N1xØ1	N2xØ2	N3	N4	O	O6	P	Q	R	R'
MTGR 710	670	772	551	415	629	27	27	39	12x12	14x12	71	39	551	437	415	110	39	27
MTGR 800	755	862	551	454	629	32	47	39	12x14	14x12	91	39	551	485	454	110	39	47
MTGR 900	850	962	551	497	629	32	47	39	12x14	14x14	91	39	551	549	497	110	39	47
MTGR 1000	950	1056	607	541	697	36	67	45	12x14	14x14	99	45	607	612	541	140	45	67
MTGR 1120	1060	1178	760	632	850	45	55	45	16x14	16x14	111	45	760	687	632	140	45	45
MTGR 1250	1190	1310	760	694	850	45	55	45	16x14	14x14	110	45	760	771	694	140	45	55
MTGR 1400	1320	1450	780	783	890	55	85	55	16x14	18x14	120	55	780	856	783	170	55	85
MTGR 1600	1500	1640	917	890	1047	60	75	65	24x14	18x14	120	65	917	955	890	210	65	75
MTGR 1800	1650	1830	917	986	1047	60	65	65	24x14	20x18	130	65	917	1072	986	210	65	65
MTGR 2000	1850	2030	917	1083	1047	60	85	65	24x17	24x18	170	65	917	1195	1083	210	65	85

MODEL	S	S1	S2	S3	S4	S5	S6	S7	T	T1	U	U'	V	V1	W	X	X1	X2
MTGR 710	690	596	497	500	937	825	719	662	27	14	772	772	807	48	1633	71	500	937
MTGR 800	782	672	562	560	1045	919	811	749	32	16	862	862	842	55	1768	91	560	1045
MTGR 900	870	721	633	630	1179	1038	905	835	32	16	962	962	987	55	2013	91	630	1179
MTGR 1000	976	813	718	710	1322	1160	1015	936	36	18	1056	1056	1036	65	2164	99	710	1322
MTGR 1120	1084	932	793	800	1487	1300	1123	1037	45	20	1178	1178	1066	75	2334	111	800	1487
MTGR 1250	1214	1048	898	900	1671	1464	1270	1163	45	20	1310	1310	1230	75	2630	110	900	1671
MTGR 1400	1325	1145	990	1000	1856	1625	1395	1272	55	22	1450	1450	1240	80	2800	120	1000	1856
MTGR 1600	1500	1277	1085	1120	2075	1814	1572	1434	60	25	1640	1640	1205	90	2965	120	1120	2075
MTGR 1800	1710	1470	1300	1250	2322	2030	1790	1610	60	28	1830	1830	1295	100	3245	130	1250	2311
MTGR 2000	1900	1634	1455	1400	2595	2267	1970	1811	60	28	2030	2030	1350	100	3500	170	1400	2595

MODEL	X3	X4	X5	X6	X7	Y	a	a1	a2	b	b1	b2	d	d1	d2	n1xp	n2xp
MTGR 710	825	719	690	662	497	180	453	497	533	322	366	402	455	497	535	2x125	3x125
MTGR 800	919	811	782	749	562	180	507	551	587	361	405	441	505	551	585	2x125	3x125
MTGR 900	1038	905	870	835	633	180	569	629	669	404	464	504	565	629	665	2x160	3x160
MTGR 1000	1160	1015	976	936	718	200	638	698	738	453	513	553	635	698	735	2x160	3x160
MTGR 1120	1300	1123	1084	1037	793	220	715	775	815	507	567	607	715	775	815	2x160	4x160
MTGR 1250	1464	1270	1214	1163	898	220	801	871	921	569	639	689	805	861	905	2x200	3x200
MTGR 1400	1625	1395	1325	1272	990	220	898	968	1018	638	708	758	905	958	1005	3x200	4x200
MTGR 1600	1814	1572	1500	1434	1085	220	1007	1077	1127	715	785	835	1007	1067	1107	3x200	4x200
MTGR 1800	2030	1790	1710	1610	1300	250	1130	1210	1270	801	881	941	1130	1200	1250	3x200	5x200
MTGR 2000	2267	1970	1900	1811	1455	250	1267	1347	1407	898	978	1038	1260	1337	1380	4x200	6x200

CONNECTION DIAGRAMS / esquema de conexiones

1 THREE PHASE MOTORS 1 SPEED / motores trifásicos 1 velocidad

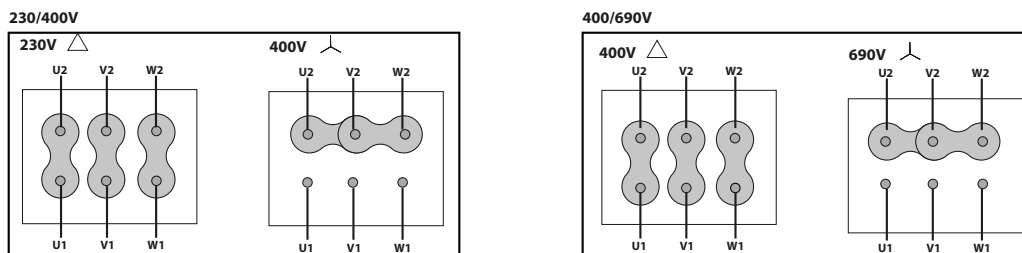



CHARACTERISTIC CURVES / curvas características

MTGR 400

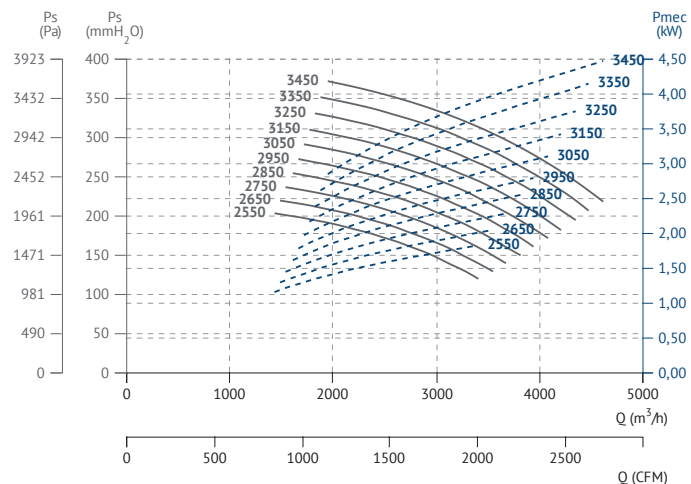

MTGR 450

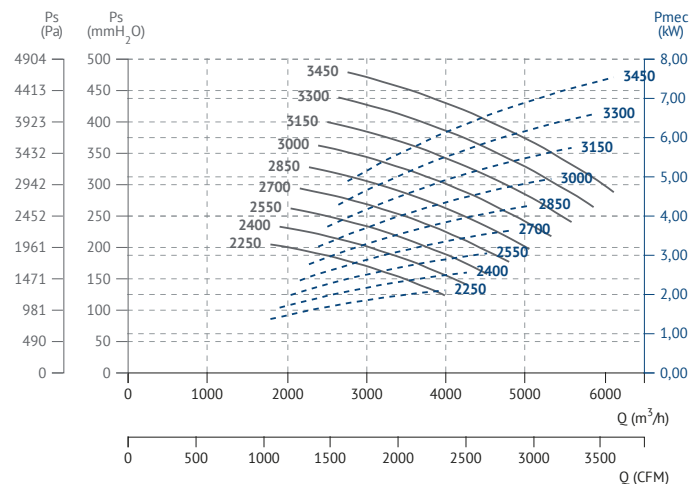

MTGR 500

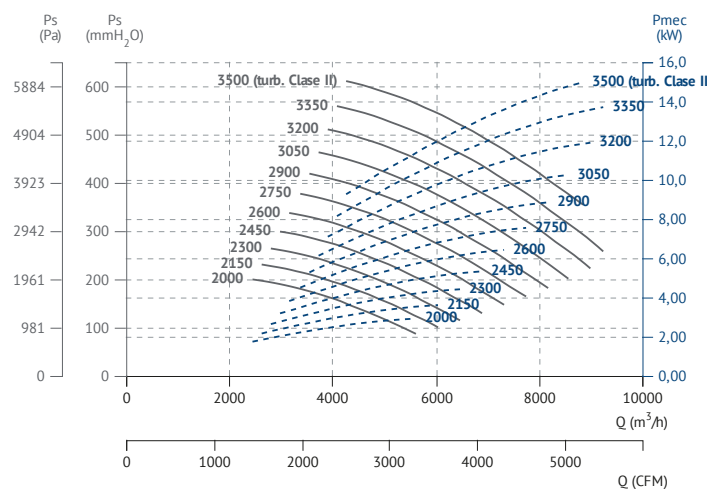

MTGR 560

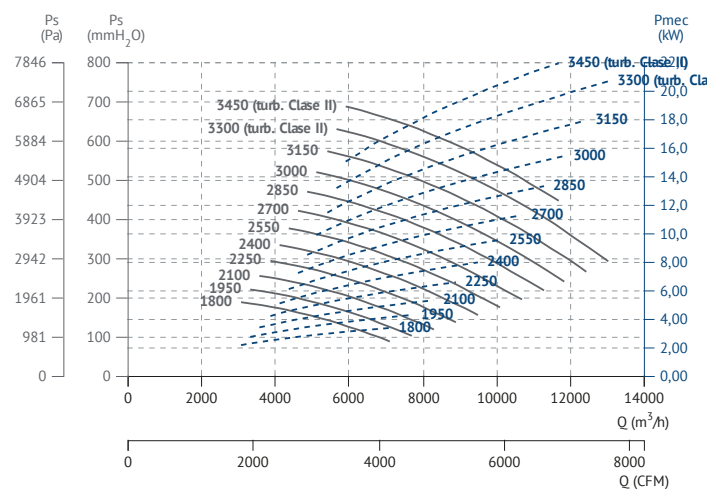

MTGR 630

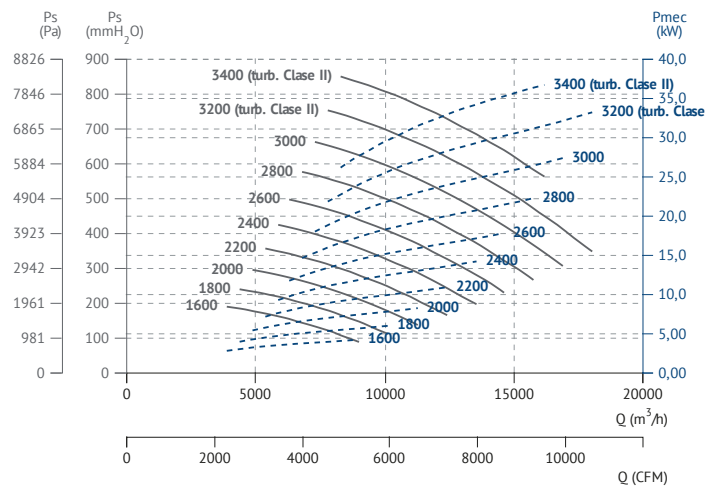

MTGR 710

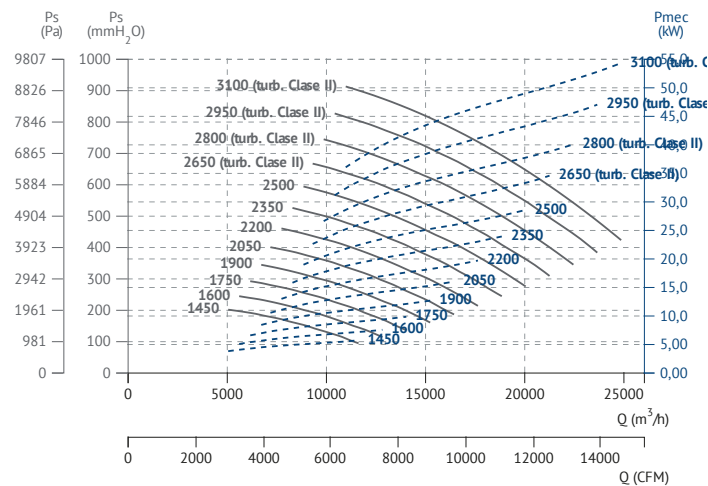



MTGR 800

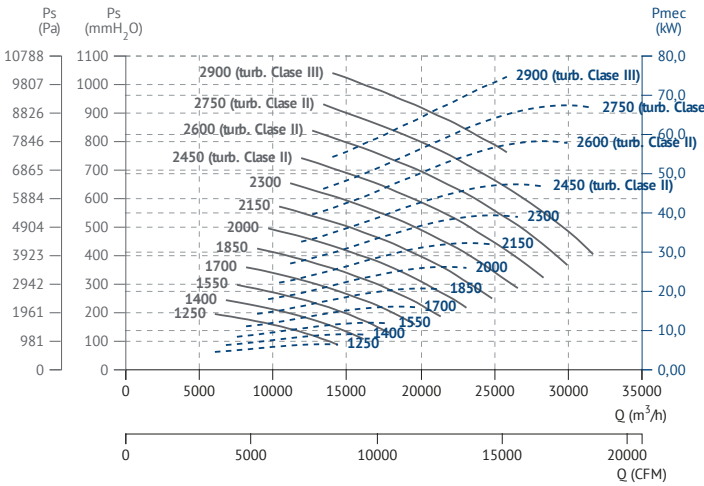

MTGR 900

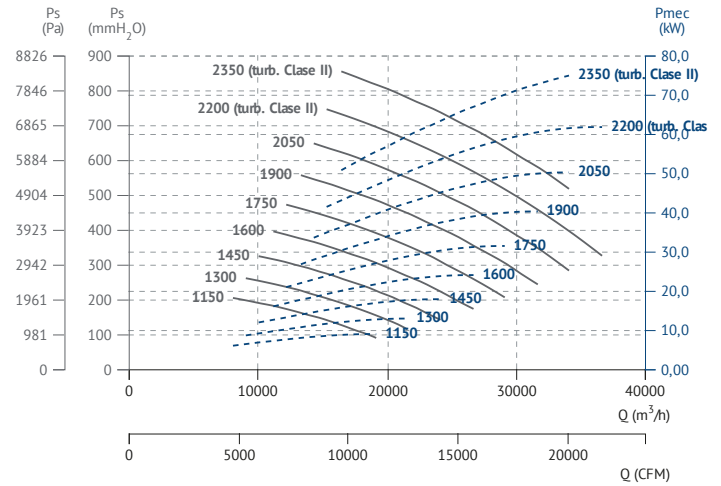

MTGR 1000

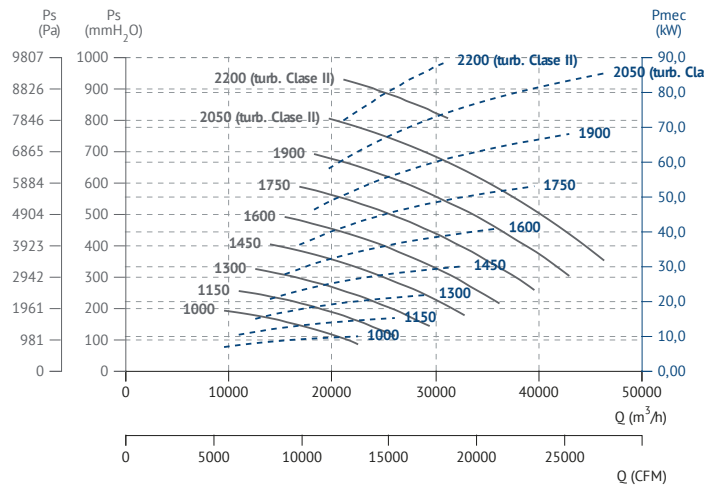

MTGR 1120

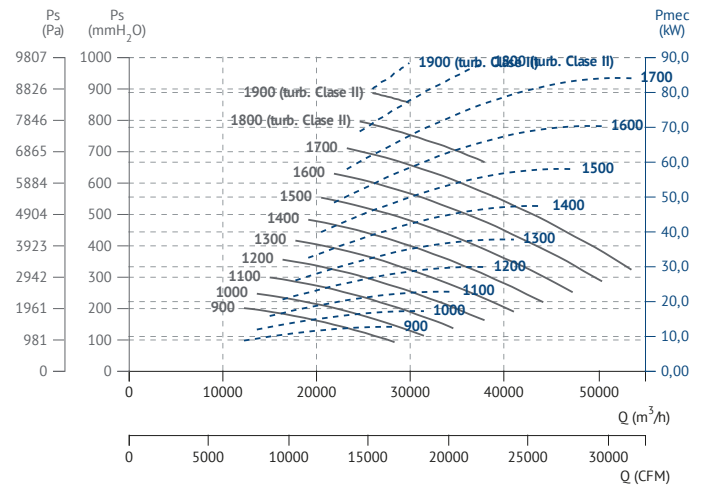

MTGR 1250

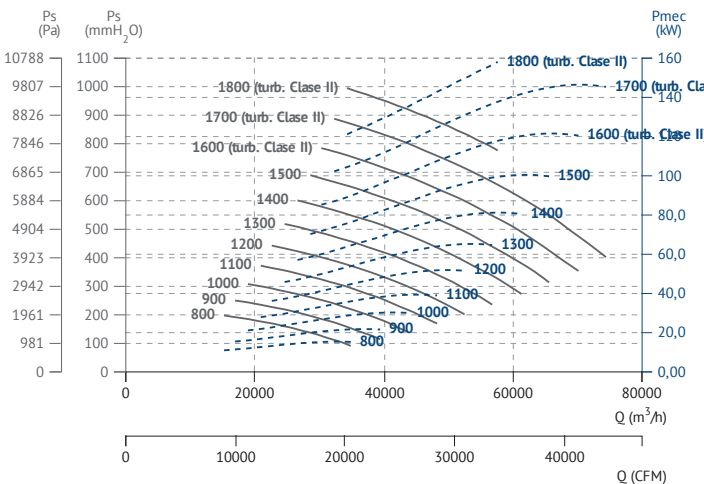

MTGR 1400

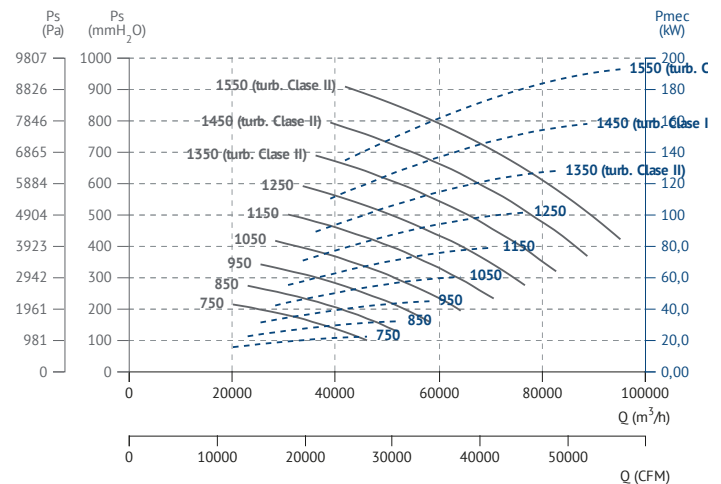



MTGR 1600

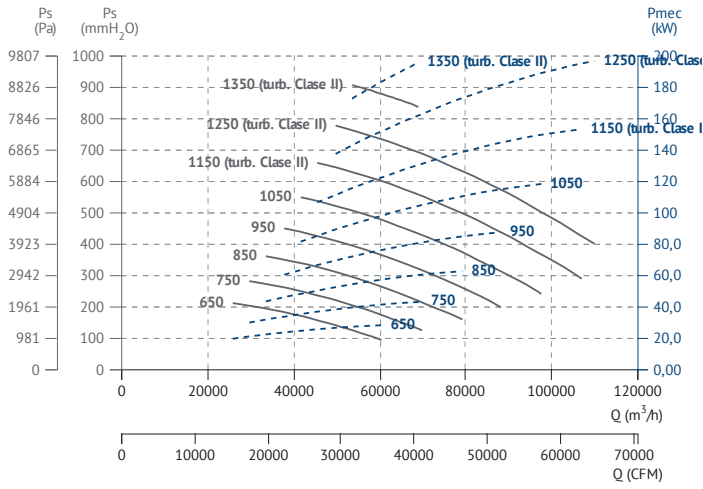

MTGR 1800

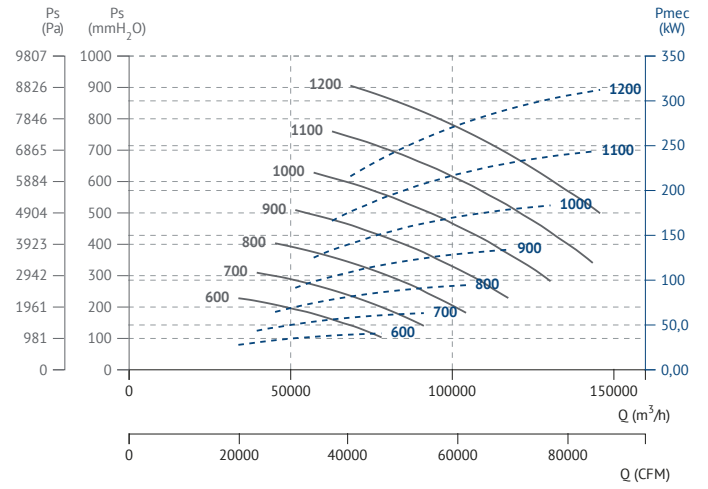

MTGR 2000

